

TOSHIBA INSTALLATION MANUAL

To Qualified Installer in Installation Work and Service

Wireless receiver kit Model: RBC-AX33UYP-E

- Thank you for purchasing Wireless receiver kit for TOSHIBA air conditioners.
 - Read this manual carefully for correct installation of the Wireless receiver before starting work.
 - After the installation is completed, execute a test run to check for normal operation and explain how to use and maintain the Wireless receiver to the customer according to the Owner's Manual.
- Ask the customer to keep this manual with the Owner's Manual.

Observe the safety precautions described in the Installation manual supplied with the ceiling panel and air conditioner (indoor unit).

Accessories

Part Name	Q'ty	Part Name	Q'ty
Wireless receiver	1	Operation Manual	1
Wireless remote controller	1	Installation Manual (this manual)	1
Remote controller holder	1	CD-ROM	1
		Battery	2
		Flat head wood screw Ø3.1 x 16R	2

Settings for the Wireless receiver before installation

Before installing the Wireless receiver, make the following setting referring to each description.

- To install the wireless remote controller together with wired remote controller, configure the "Multiple remote controller installation"
- When ceiling height exceeds the standard height (factory default), refer to the "Installing indoor unit on high ceiling" on installation manual of the indoor unit.

How to install the Wireless receiver

Install the Wireless receiver in correct orientation, since the Wireless receiver can be installed at only one corner as shown in. (Fig. 1)

1. Remove the adjust corner cap at the corner where the Wireless receiver is to be installed. (Fig. 2)
- Pull the edge of the adjust corner cap in the direction of arrow.
- Remove strap from the pin and detach the adjust corner cap from the ceiling panel.

(Fig. 2)

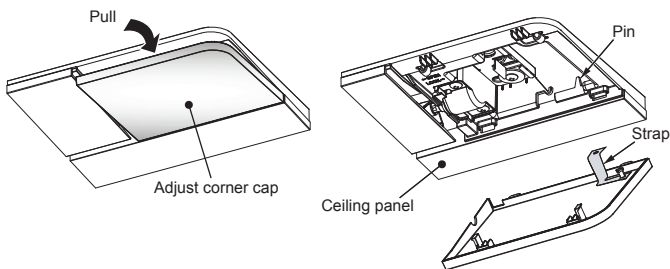

2. Wiring the wireless receiver lead wire through to the clamp in the back side of the ceiling panel.

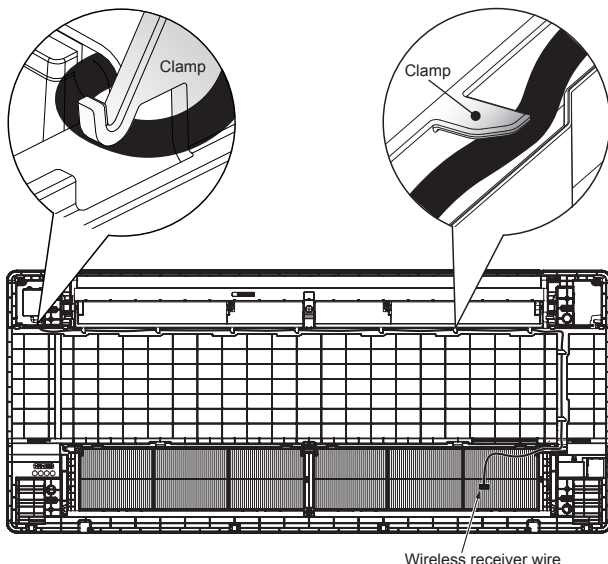

3. Attach the Wireless receiver cap to the ceiling panel.
 - Hook the strap of the Wireless receiver cap securely to the pin.
 - Insert the two claws A of the Wireless receiver cap into the rectangular holes of the ceiling panel in the direction of arrow.
 - Push the Wireless receiver cap so that the two claws B on the back of the cap are fitted.

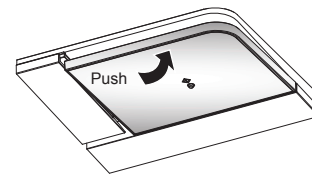
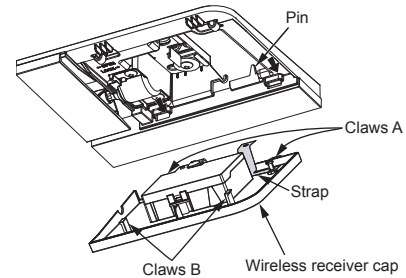

CAUTION

Press the two claws B of the adjust corner cap firmly as far as they will go, and then check that the adjust corner cap is closely attached. Failure to do so may result in water leakage.

4. Connecting wires of Wireless receiver.
 - Remove the screw of the electrical control box cover, and detach the electrical control box cover by slide. (The electrical control box cover is clamped onto the hinge.)
 - Pass the wireless receiver wire from the ceiling panel through the clammer as shown, and connect the wire to connector CN214 on the P.C. board of the indoor unit.
 - * Connect the wire firmly to the connector to ensure operation of the Wireless receiver.
 - Attach the electrical control box cover by reversing the procedure of detaching.
 - * Make sure that no wire is caught between the electrical control box and the cover.
 - * Make sure that no wire is caught between the indoor unit and the ceiling panel.

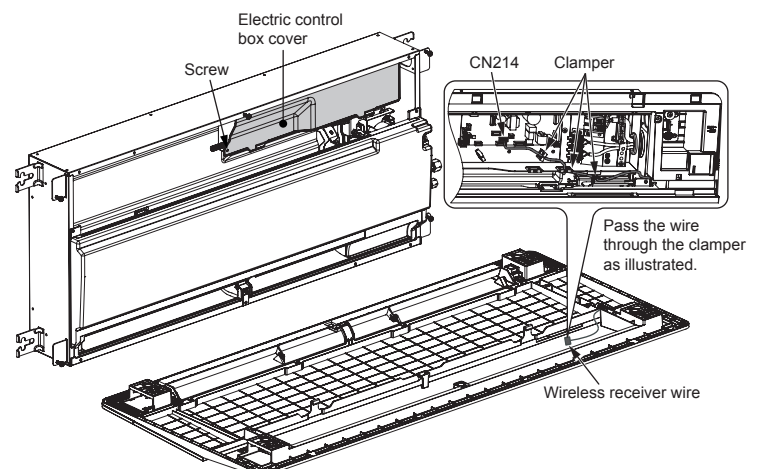

Wire Connection (For illustrative purpose the orientation of the indoor unit is not the actual orientation)

Remote controller address (A-B selection) setting

- When two or more wireless receiver are installed in a room, a unique address can be set for each wireless receiver to prevent interference.
- Address (A-B selection) must be changed on wireless remote controller.

Test run (Forced cooling operation)

Requirement

- Finish the forced cooling operation in a short time because it applies excessive strength to the air conditioner.

How to perform forced cooling operation

1. When TEMPORARY button is pushed for 10 seconds or more, "Pit" sound is heard and the operation changes to a forced cooling operation. After approx. 3 minutes, a cooling operation starts forcedly. Check cool air starts blowing. If the operation does not start, check wiring again.
 2. To stop a test operation, push TEMPORARY button once again (Approx. 1 Sec.).
- Check wiring / piping of the indoor and outdoor unit in forced cooling operation.

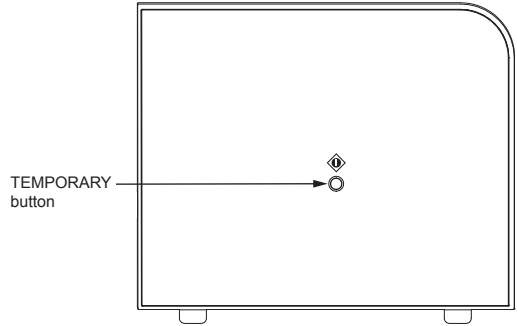

Preparation and check before use

1. Loading Batteries
 - Remove the battery cover.
 - Insert 2 new batteries (R03 [AAA]) following the (+) and (-) positions.
2. Removing Batteries
 - Remove the battery cover.
 - Remove the 2 used batteries.

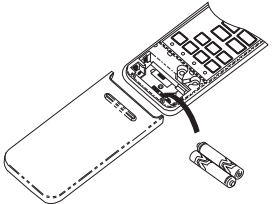

Batteries

- To replace the batteries, use two new batteries (R03 [AAA]).
- In normal use, the batteries will last about one year.
- Replace the batteries if there is no receiving beep from the indoor unit or when the air conditioner cannot be operated using the remote controller.
- To avoid malfunctions by battery leakage, remove the batteries when not using the remote controller for more than one month.
- Please dispose of the used batteries according to the local regulation.

Installing the remote controller holder

- Before you actually install the remote controller holder on a wall or pillar, check whether the remote controller signals can be received by the indoor unit.

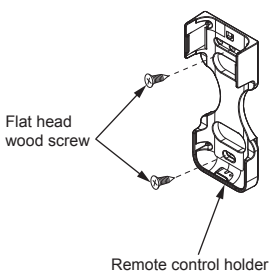

Mounting and removing the remote controller

- To mount the remote controller hold it parallel to the remote controller holder and push it in fully. To remove the remote controller slide the remote controller upwards and out from the holder.

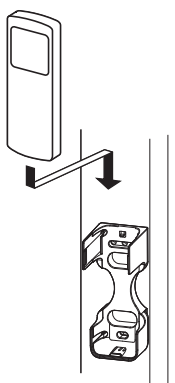

Self-diagnosis function and measures

- The following table shows a few examples. For details of indoor unit errors, refer to the Installation Manual of the indoor unit.

LED	Possible cause	Measures
<p>These LEDs do not light or blink even if the remote controller is operated.</p>	- Power is not turned on. - Incorrect connection between signal receiving unit and indoor unit	
	Loose connection between signal receiving unit and indoor unit	Check connections and reconnect wires correctly, if necessary.
	Incorrect or loose connection between indoor unit and outdoor unit	
	The protective device of the outdoor unit is activated.	Check the outdoor unit.
	The protective device of the indoor unit is activated.	Check the indoor unit.

LEDs on the signal receiving unit ● : OFF ☀ : Blinking (at intervals of 0.5 seconds)

Notes on installing remote controller

- When using a wireless remote controller in the remote controller holder on a wall, turn on a fluorescent light and operate the remote controller at the installation position. Make sure that the air conditioner operates normally and then secure the remote controller holder on the wall.
- When installing a remote controller that senses room temperature with the sensor, avoid the following places.
 - A place exposed to direct cool air, warm air or direct sunlight.
 - A place subject to thermal effects.

Explanation to the customer

- After the installation work has been completed, execute a test run to check for normal operation and then hand the customer the Owner's Manual and Installation Manual of the wireless remote controller kit.
- Explain how to use and maintain the wireless remote controller kit to the customer according to the Owner's Manual of the wireless remote controller kit.

List of separately available products that cannot be used with the Wireless receiver kit.

The following separately available products cannot be used together with the Wireless receiver kit.

Product name	Model
Occupancy sensor kit	TCB-SIR41UYP-E